

EINBAU-Skizze 135° / DIN - rechts = Art.-Nr.: 20_1008_12_XX_42

Glasbearbeitung bei Verwendung von

Magnetdichtungen Nr. 20 1160 11 27 06 und Nr. 20 1161 11 27 06

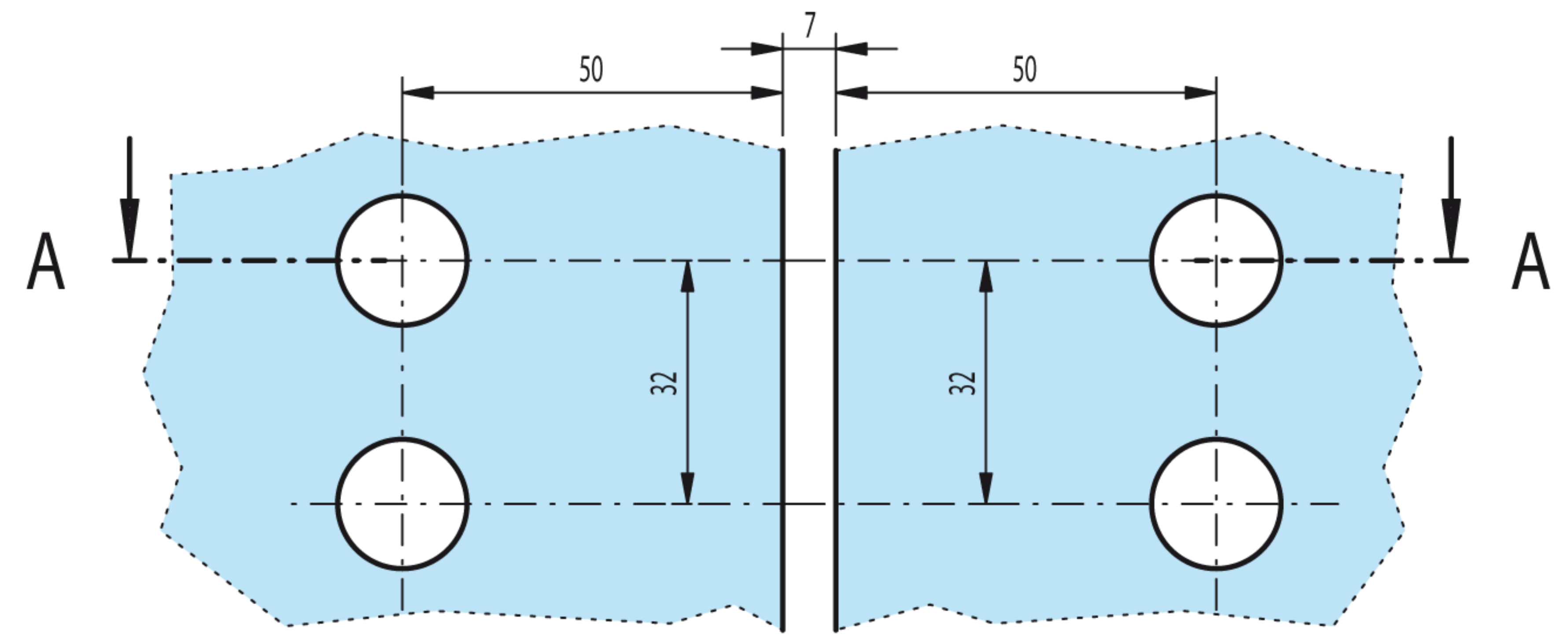

Flügelglas

Flügelglas

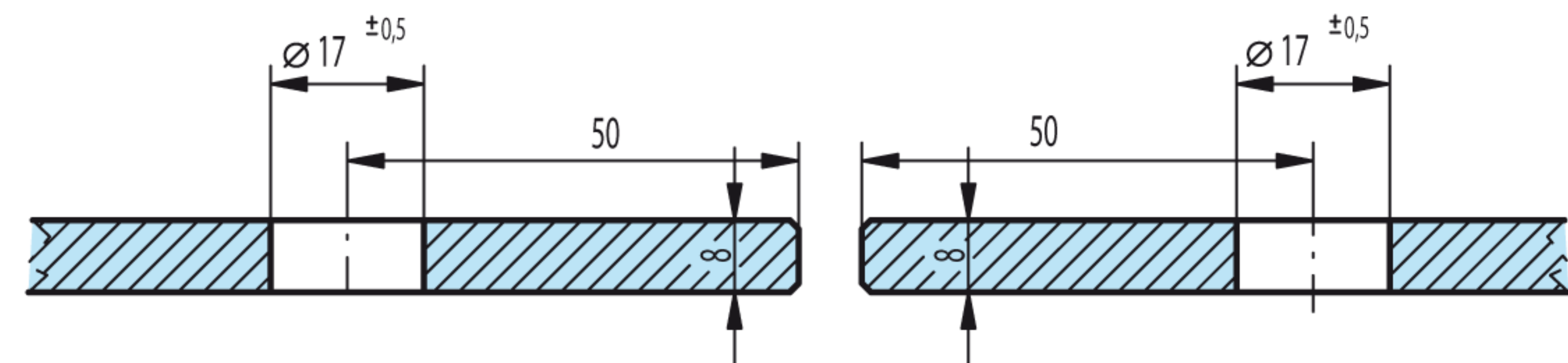

Schnitt: A-A (M1:1)

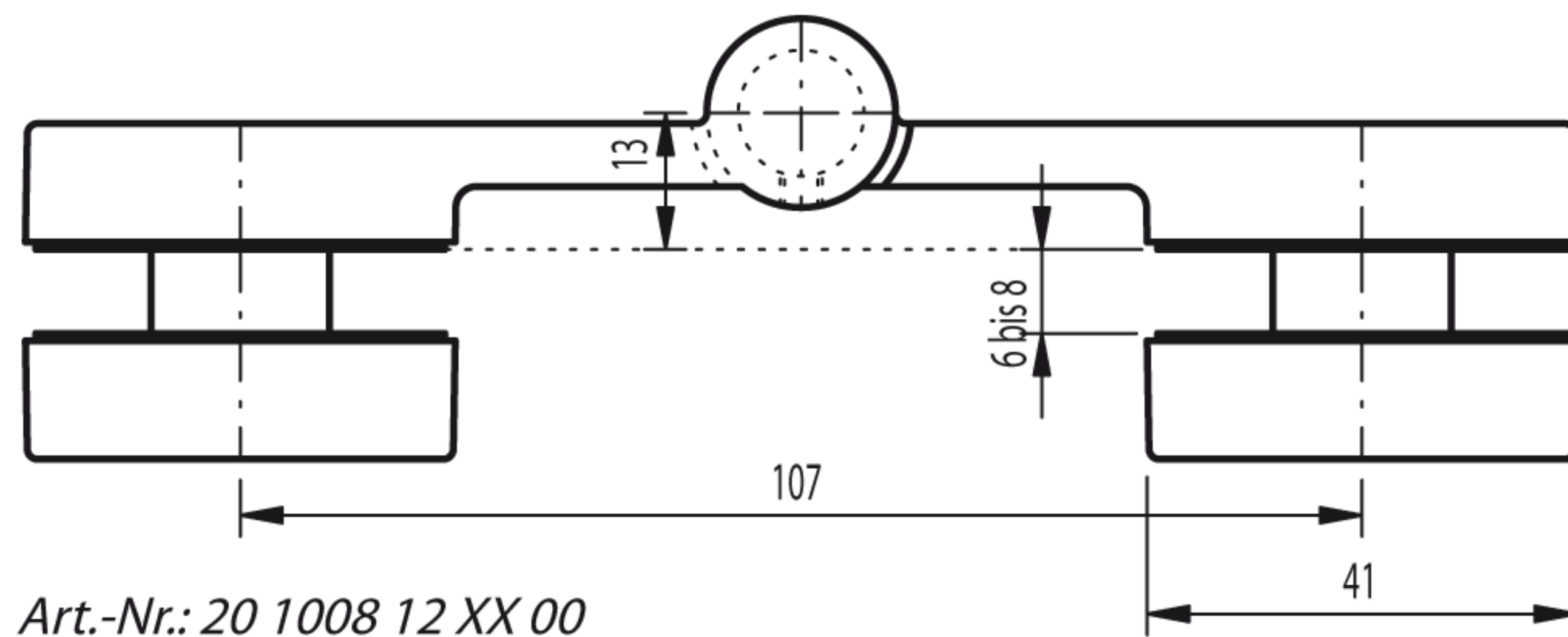
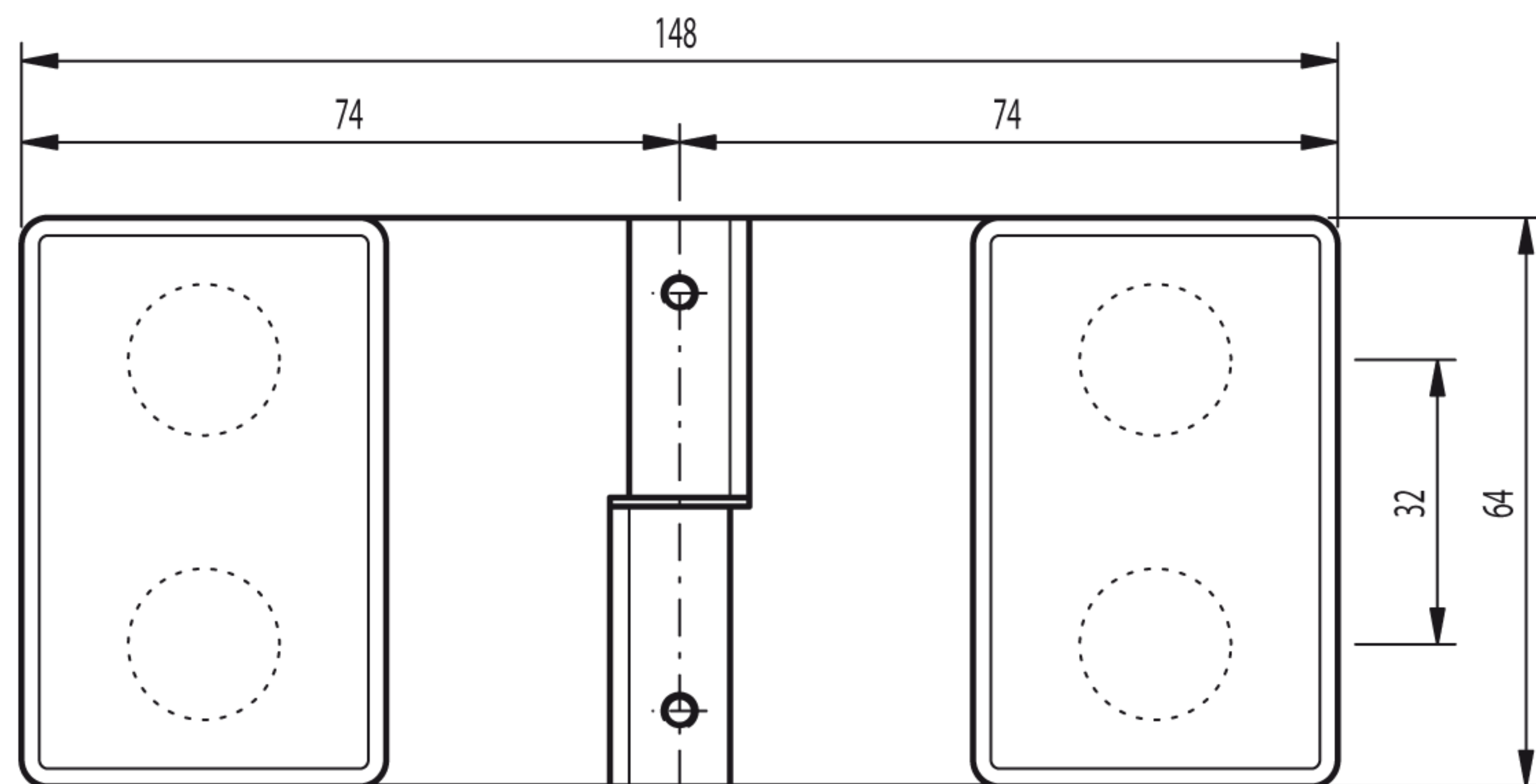

Art.-Nr.: 20 1008 12 XX 00

